



*jordan fishwick*

**NORTHENDEN**  
Overwood Road



## Overwood Road, Northenden, M22 4JB

Guide Price £380,000



### The Property

An appealing, bay fronted, three bedroom semi detached property which has bene well cared for over the years and enjoys a great location at the end of a small cul-de-sac close to Northenden Village. The accommodation is warmed by gas central heating, which is further complemented by uPVC double glazed windows & doors, with numerous other noteworthy features including a through lounge/dining room over 26ft with sun room off, 17ft fitted breakfast kitchen with a range of units, three good sized bedrooms with fitted wardrobes, bathroom with four-piece suite, lovely gardens to the front and rear and a generous driveway providing ample parking, in turn leading to an 18ft detached garage. \*No Onward Chain\*

### Directions

M22 4JB

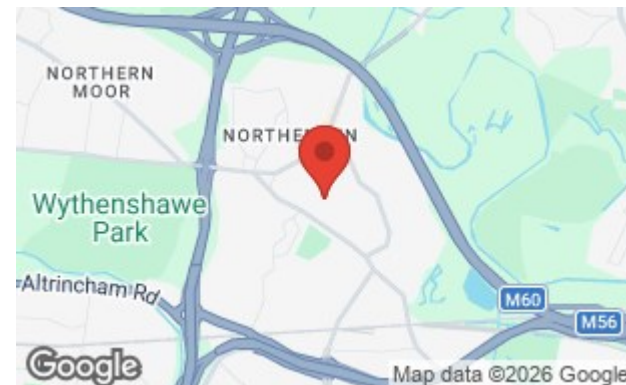

- Lovely semi-detached property
- Cul-de-sac location
- Three good sized bedrooms
- Lounge/dining room over 26ft
- Fitted kitchen over 17ft & sun room
- Four-piece bathroom
- uPVC double glazing
- Gas central heating
- Generous gardens, driveway & garage
- No onward chain

Postcode - M22 4JB

EPC Rating - C

Floor Area - 1008.00 sq ft

Local Authority - Manchester City Council

Council Tax - C



GROUND FLOOR  
562 sq.ft. (52.2 sq.m.) approx.



1ST FLOOR  
446 sq.ft. (41.5 sq.m.) approx.

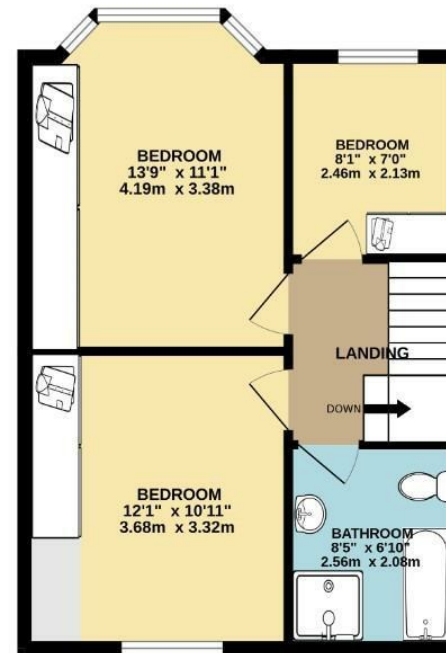

TOTAL FLOOR AREA: 1008 sq.ft. (93.6 sq.m.) approx.  
Measurements are approximate. Not to scale. Illustrative purposes only.  
Made with Metropix ©2026



These particulars are believed to be accurate but they are not guaranteed and do not form a contract. Neither Jordan Fishwick nor the vendor or lessor accept any responsibility in respect of these particulars, which are not intended to be statements or representations of fact and any intending purchaser or lessee must satisfy himself by inspection or otherwise as to the correctness of each of the statements contained in these particulars. Any floorplans on this brochure are for illustrative purposes only and are not necessarily to scale.

Offices also at: Wilmslow, Macclesfield, Hale, Sale, Chorlton, Glossop, Manchester & Salford

757-759 Wilmslow Road, Didsbury Village, Manchester

0161 445 4480

didsbury@jordanfishwick.co.uk  
www.jordanfishwick.co.uk